

# Westmount Estates



Court Road, Mottingham, SE9 4TX

**£1,400 PCM**

If you are wanting space then this property has lots to offer with approximately over 70m<sup>2</sup> of living accommodation. This spacious apartment has been decorated to a high standard throughout. The property internally includes a living room, modern fitted kitchen, bedroom and bathroom. Other benefits include double glazing through out, gas central heating and parking space to front.

**ENTRANCE HALL**

Centre light point, ornate coved cornices, radiator, skirting, wooden effect laminate flooring.

**LIVING ROOM 16'10" x 14'5" (5.13 x 4.39)**

Feature fireplace surround and hearth, double glazed windows to rear, centre light point, ornate coved cornices, radiator, skirting, wooden effect laminate flooring.

**KITCHEN 12'9" x 12'4" (3.89 x 3.76)**

Modern fitted kitchen with a range of eye and base units with tiled work surfaces, built in gas hob cooker with extractor fan above and oven under, space for washing machine and dishwasher, built in fridge/freezer, double glazed door and window to rear, centre light point, ornate coved cornices, skirting, wooden effect laminate flooring.

**BEDROOM 18'1" x 14'5" (5.51 x 4.39)**

Double glazed window to front, centre light point, ornate coved cornices, radiator, skirting, wooden effect laminate flooring.

**BATHROOM 12'10" x 6'7" (3.91 x 2.01)**

Double glazed frosted window to front, in built standing shower cubical, tile enclosed bath with mixer tap, low level w.c, wash hand basin with wall mounted mirror above, tiled splash zone, centre light point, wooden effect tiled flooring.

# Floor Plan

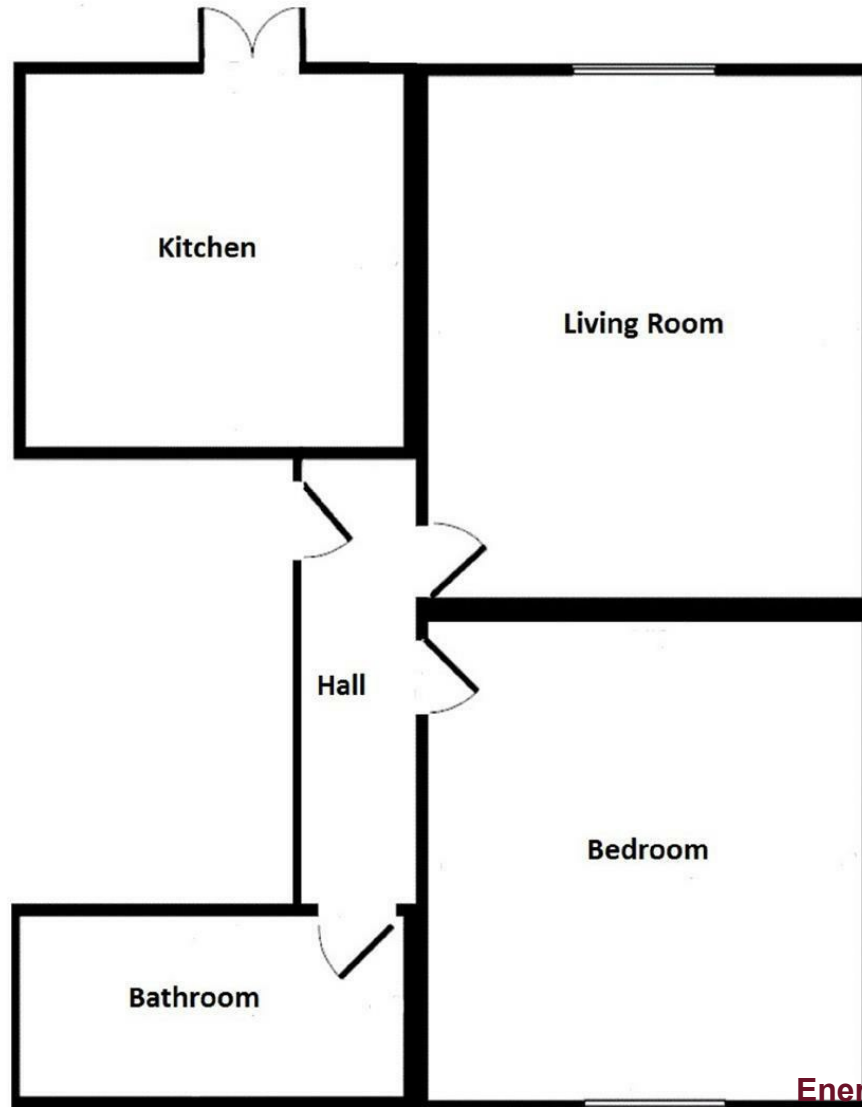

## Area Map

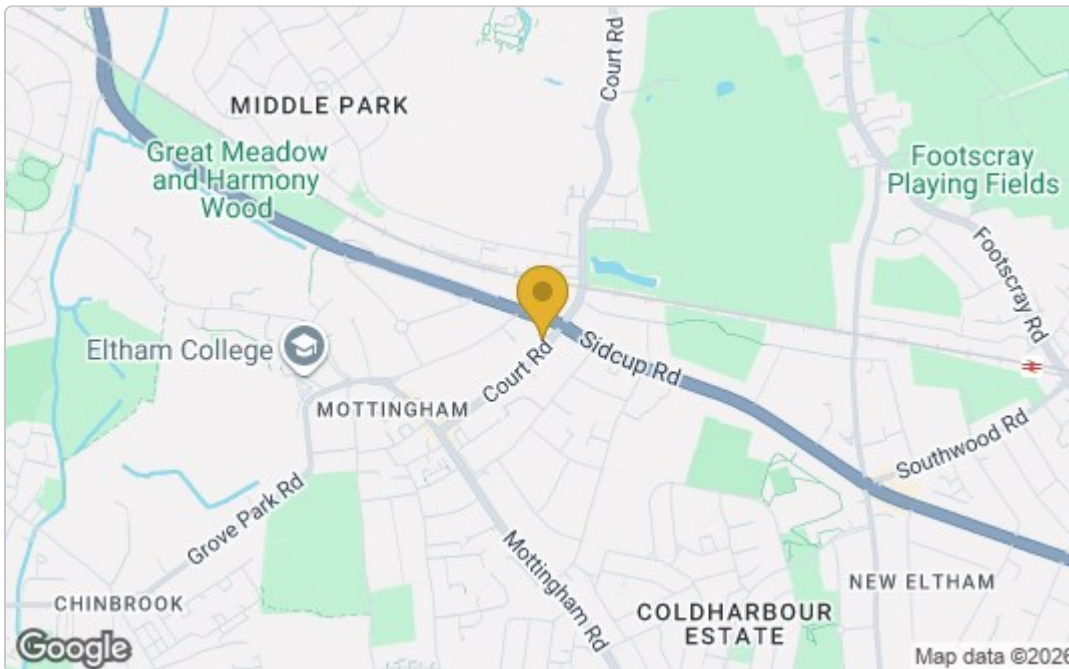

## Energy Efficiency Graph

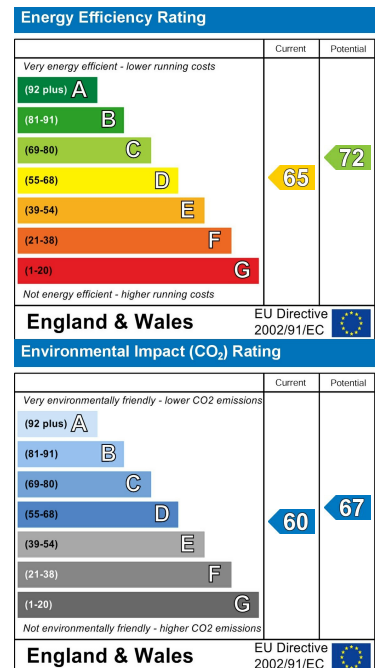

These particulars, whilst believed to be accurate are set out as a general outline only for guidance and do not constitute any part of an offer or contract. Intending purchasers should not rely on them as statements of representation of fact, but must satisfy themselves by inspection or otherwise as to their accuracy. No person in this firm's employment has the authority to make or give any representation or warranty in respect of the property.